

# ADAPTORS, REDUCERS & STOPPING PLUGS

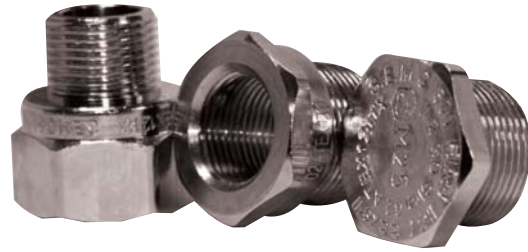

Zone 1,2,21,22



## APPLICATION :

Suitable for both industrial use and in either zone 1 or zone 2 approved equipment having flameproof Ex d, increased safety Ex'e', or NON - Incentive Ex'n/Ex'nR' methods of protection.

## SPECIFICATION :

"Ex d IIC/Ex e IIC,Ex t IIIC" in accordance with the relevant requirements of IEC 60079-0 , IEC 60079-1, IEC 60079-7 , IEC 61241-0 , IEC 61241-1, IEC 60079-31

## CERTIFICATION :

Component certificate No. : TÜV 11 ATEX 7157 U and equipment certificate No. TÜV11 ATEX 7156 X

## FUNCTION :

Provides a means of outdoor or indoor connection between cable entry device and equipment having dissimilar threads.

## INGRESS PROTECTION :

IP 66 TO BS EN 60529.

## MATERIAL :

Brass, aluminum, mild & stainless steel .

## FINISH :

May be coated or plated to suit the application .

## THREAD FORMS :

See thread conversion table .

## MARKING :

Surface engraving.

## HAZARDOUS AREA CONSIDERATIONS :

For hazardous area application S.E.M.C. range of Adaptors, Reducers, & Stopping Plugs can be supplied as Certified Components appropriate for use on areas classified as Zone I or Zone II, in conjunction with any equipment Certified as Flameproof Exd, Increased Safety Exe, or Non Incentive Exn / ExnR.

The following considerations shall be taken into account while using Certified Adaptors, Reducers, & Stopping Plugs as well as "Good engineering practices" :

- \* For any cable entry, only one thread convertor ( Adaptor or Reducer ) can be used.
- \* Stopping Plugs are not permitted to be fitted into an Adaptor or Reducer. They should directly be fitted into unplugged / unused cable entries of the equipment.
- \* Female entry threads of adaptors, can only be one step greater than the nominal size of the male thread form.

S.E.M.C. range of Adaptors , Reducers, & Stopping Plugs cover the most popular international thread forms including: Metric, Imperial, NPT, PG, BSPP,and BSPT(see " Thread Conversion Table).

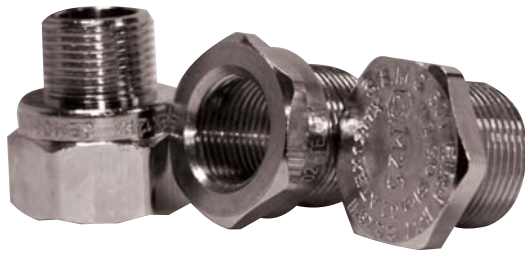

# ADAPTORS, REDUCERS & STOPPING PLUGS



Zone 1,2,21,22

## SHOMAL TYPE 700 Plug

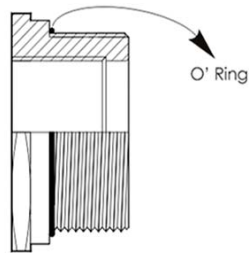

PLUG SIZE	Across Corner	Across Flat (min)
M16	22.5	20
M20	26.6	24
M25	33.3	30
M32	39.9	36
M40	49.9	44
M50	61.0	55
M63	77.6	68
M75	90.3	80
M90	113	100

All dimensions are in millimetres

## SHOMAL TYPE 600 ADAPTORS

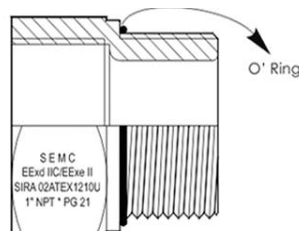

ADAPTOR		Across Corner	Across Flat (min)	Bore
Male	Female			
M16	M20	26.6	24	9.5
M20	M25	33.3	30	14.0
M25	M32	39.9	36	20.0
M32	M40	49.9	44	26.5
M40	M50	61.0	55	32.0
M50	M63	77.6	68	44.0
M63	M75	90.3	80	56.0
M75	M90	113	100	68

All dimensions are in millimetres

All information may be revised or changed by SHOMAL at anytime without prior notice or explanation.

# ADAPTORS, REDUCERS & STOPPING PLUGS



Zone 1,2,21,22

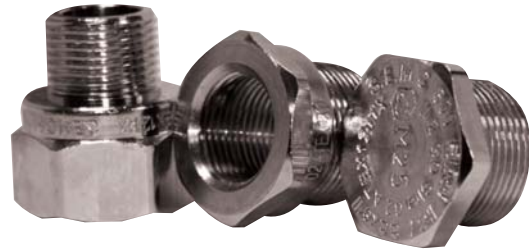

## SHOMAL TYPE 800 Reducer

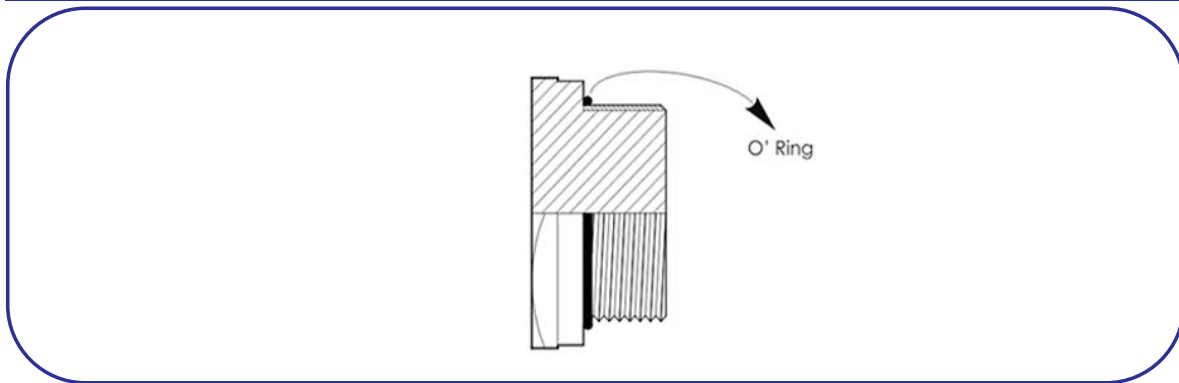

Reducer Male	Across Corner	Across Flat (min)
M16	22.5	20
M20	26.6	24
M25	33.3	30
M32	39.9	36
M40	49.9	44
M50	61.0	55
M63	77.6	68
M75	90.3	80
M90	113	100

All dimensions are in millimetress

